

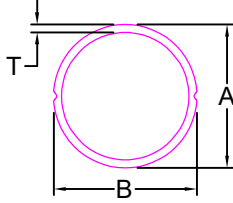

TEXTILE

2 SLOT ROUND TUBE



SL NO.	SECTION NO.	A	B	T	WEIGHT KG/12'
1	1661	36.0	32.0	2.00	3.200-3.350
2	1662	41.0	37.50	2.00	2.700-2.800
3	1663	42.0	37.50	2.25	3.200-3.350

3 SLOT ROUND TUBE

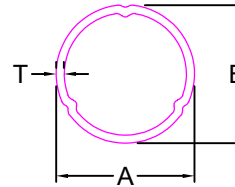

SL NO.	SECTION NO.	A	B	T	WEIGHT KG/12'
1	1650	31.60	28.20	1.70	1.500-1.650
2	1651	35.60	32.30	1.65	1.650-1.720
3	1652	35.80	32.40	1.70	1.725-1.800
4	1653	35.90	32.40	1.75	1.800-1.900
5	1654	36.00	32.30	1.85	1.900-2.000
6	1655	36.00	32.20	1.90	2.000-2.400
7	1656	42.00	38.00	2.00	2.600-2.800

FLUTED ROUND TUBE

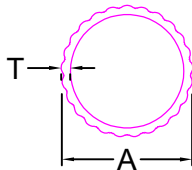

SEC. NO.	A	B	WT. kg./mtr	Weight KG/12'
1671	24.00	0.35	0.105	0.375-0.400
1672	24.00	0.46	0.126	0.450-0.500
1673	24.00	0.53	0.137	0.500-0.600
1674	24.00	0.67	0.163	0.600-0.700
1675	24.00	0.81	0.191	0.700-0.800
1676	24.00	0.96	0.219	0.800-0.900
1677	24.00	1.11	0.246	0.900-1.000
1678	25.80	2.70	0.382	1.400-1.500

SEC No. 7336

Weight :-2.335kg/12'

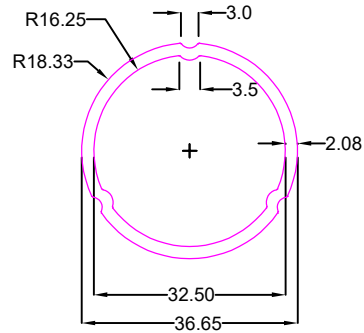

SEC No. 7337

Weight :-2.100kg/12'

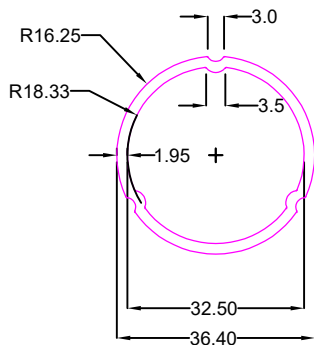

SEC No. 7489

Weight :-6.500kg/12'

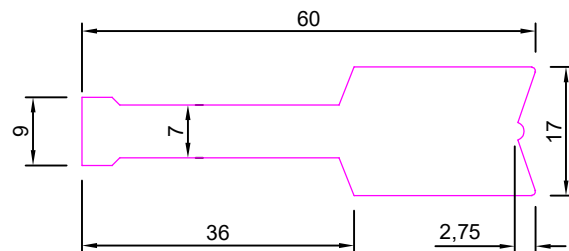



TEXTILE

SEC No. 7580

Weight :-1.100kg/12'

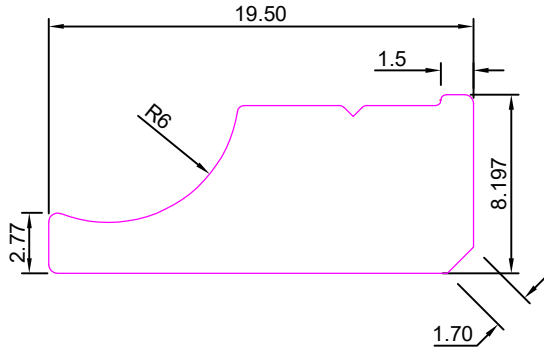

SEC No. 7816

Weight:-13.200Kg/12'

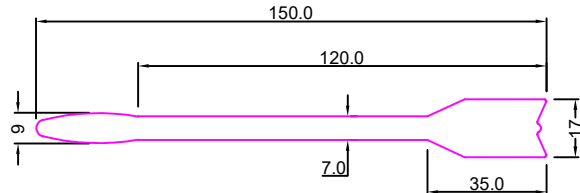

SEC No. VA7936

Weight:2.100Kg/12'

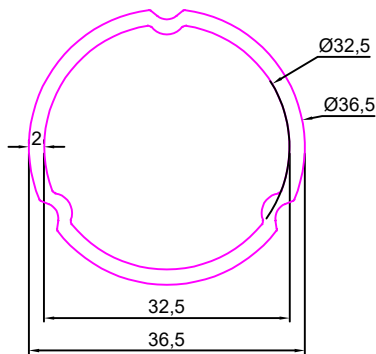

SEC No. VA7969

Weight:-2.120-2.170Kg/12'

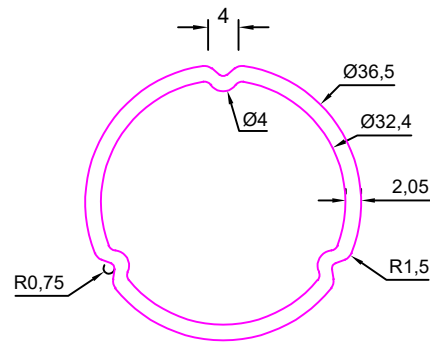

SEC No. VA7970

Weight:-2.270-2.320Kg/12'

