

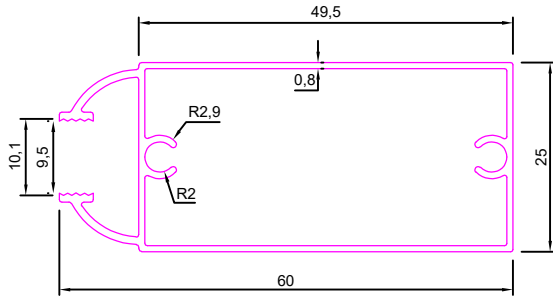

MOLDING

SEC. NO:-3351

Weight :- 1.625kg/12'



SEC. NO:-3353

Weight :- 2.030kg/12'

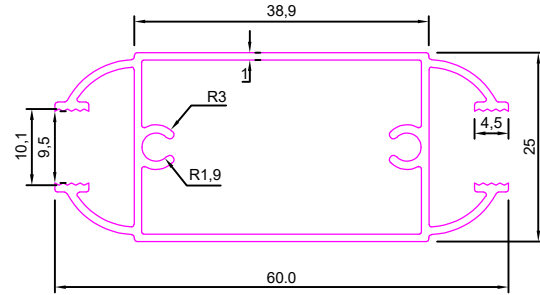

SEC. NO:-3355

Weight :- 2.265kg/12'

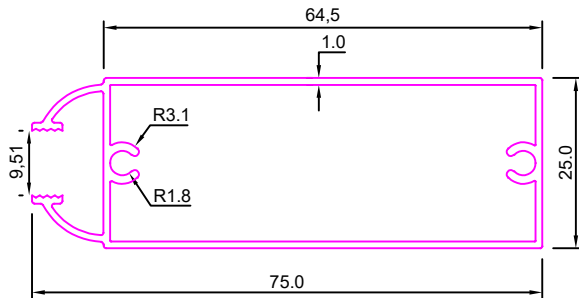

SEC. NO:-3357

Weight :- 1.625kg/12'

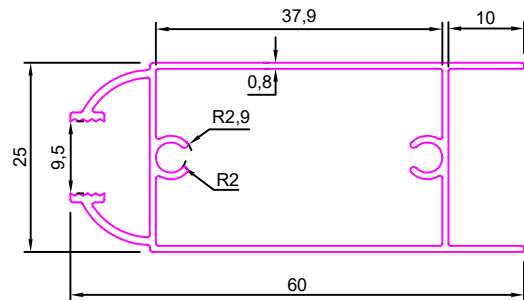

SEC. NO:-3359

Weight :- 2.145kg/12'

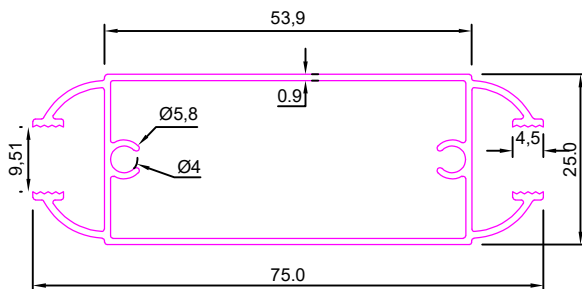

SEC. NO:-3361

Weight :- 1.580kg/12'

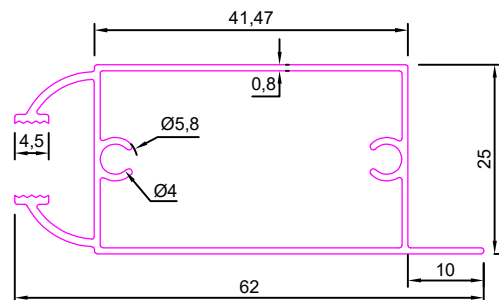



MOLDING

SEC. NO:-3363

Weight :- 1.860kg/12'

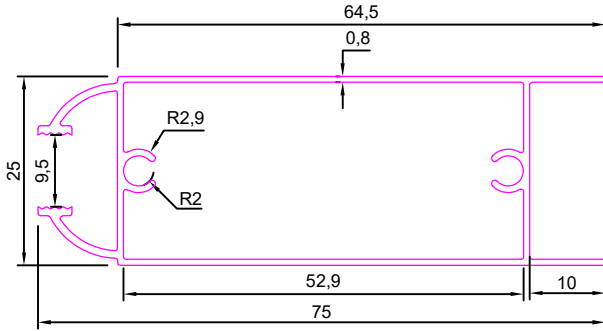

SEC. NO:-3365

Weight :- 1.700kg/12'

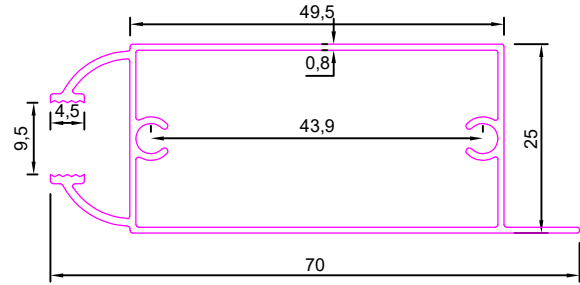

SEC. NO:-3367

Weight :- 2.775kg/12'

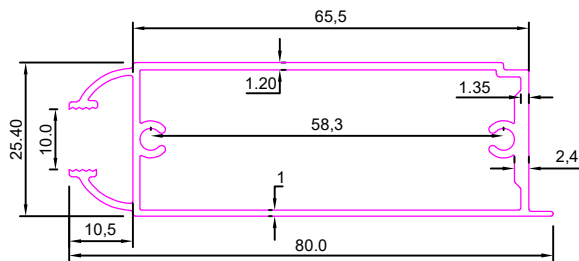

SEC. NO:-3369

Weight :- 3.030kg/12'

